

■ STEEL

■ DOUBLE FLANGE

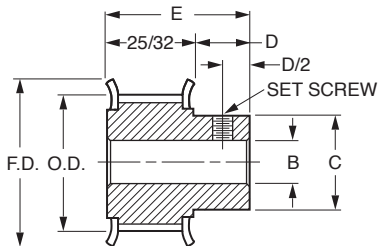

SECTION A-A



FOR 1/2" BELTS

MATERIAL: Steel

FINISH: Black Oxide

Catalog Number	No. of Grooves	P.D. (REF)	O.D.*	F.D. ± 1/64	B Bore +.001 - .000	E Length ± 1/64	C Hub Dia. ± 1/64	D Hub Proj.	Set Screw
A 6F 4-10DF5012	10	1.194	1.164	1.42	.375	1-9/64	.81	23/64	#10-24
A 6F 4-10DF5016					.500				
A 6F 4-12DF5012					.375				
A 6F 4-12DF5016	12	1.432	1.402	1.65	.500	1-1/4	1.06	31/64	#10-24
A 6F 4-14DF5012					.375				
A 6F 4-14DF5016					.500				
A 6F 4-16DF5012	14	1.671	1.641	1.89	.375	1-1/4	1.13	31/64	#10-24
A 6F 4-16DF5016					.500				
A 6F 4-17DF5012					.375				
A 6F 4-17DF5016	16	1.910	1.880	2.13	.500	1-25/64	1.44	39/64	1/4-20
A 6F 4-18DF5012					.375				
A 6F 4-18DF5016					.500				
A 6F 4-19DF5012	17	2.029	1.999	2.24	.375	1-25/64	1.50	39/64	1/4-20
A 6F 4-19DF5016					.500				
A 6F 4-20DF5012					.375				
A 6F 4-20DF5016	18	2.149	2.119	2.36	.500	1-25/64	1.56	39/64	1/4-20
A 6F 4-21DF5012					.375				
A 6F 4-21DF5016					.500				
A 6F 4-22DF5012	19	2.268	2.238	2.52	.375	1-25/64	1.63	39/64	1/4-20
A 6F 4-22DF5016					.500				
A 6F 4-24DF5012					.375				
A 6F 4-24DF5016	20	2.387	2.357	2.62	.500	1-25/64	1.69	39/64	1/4-20
A 6F 4-21DF5012					.375				
A 6F 4-21DF5016					.500				
A 6F 4-22DF5012	21	2.507	2.477	2.76	.375	1-7/16	1.88	43/64	1/4-20
A 6F 4-22DF5016					.500				
A 6F 4-24DF5012					.375				
A 6F 4-24DF5016	22	2.626	2.596	2.95	.500	1-1/2	2.00	47/64	1/4-20
A 6F 4-26DF5012					.375				
A 6F 4-26DF5016					.500				
A 6F 4-28DF5012	24	2.865	2.835	3.11	.375	1-1/2	2.25	47/64	1/4-20
A 6F 4-28DF5016					.500				
A 6F 4-30DF5012					.375				
A 6F 4-30DF5016	26	3.104	3.074	3.39	.500	1-1/2	2.25	47/64	1/4-20
A 6F 4-32DF5012					.375				
A 6F 4-32DF5016					.500				
A 6F 4-28DF5012	28	3.342	3.312	3.58	.375	1-1/2	2.25	47/64	1/4-20
A 6F 4-28DF5016					.500				
A 6F 4-30DF5012					.375				
A 6F 4-30DF5016	30	3.581	3.551	3.82	.500	1-1/2	2.25	47/64	1/4-20
A 6F 4-32DF5012					.375				
A 6F 4-32DF5016					.500				
A 6F 4-32DF5012	32	3.820	3.790	4.02	.375	1-41/64	2.56	55/64	1/4-20
A 6F 4-32DF5016					.500				

*O.D. Tolerance: 10 to 17 grooves is +.003, -.000
18 to 32 grooves is +.004, -.000